

Gas Actuated Thermometers

Process Industry Series • Model 73
with Adjustable Stem and Dial

Thermometers

Service intended

All stainless steel thermometer. Suitable for corrosive media and environments in chemical process, petroleum and food industry. The instruments meet the highest standards of measurement technique.

Nominal size

100 and 160 mm

Temperature element

Inert gas expansion system (non-toxic)

Accuracy

Class 1 per DIN EN 13 190

Working range

Permanent (1 year): measuring range per DIN EN 13 190

Short time (24 h max.): scale range per DIN EN 13 190

Pressure rating of stem

25 bar maximum

Nominal use

DIN EN 13 190

Ingress protection

IP 56 / IP 65 per EN 60 529 / IEC 529

IP 65 per EN 60 529 / IEC 529 for gauges with alarm contacts

Standard features

Location of stem

Centre back

Case

Rotatable on stem 360°

Stem adjustable every angle

Material: stainless steel

Bezel

Cam ring (bayonet type) bezel, natural finish stainless steel

Connection

Plain stem, stainless steel 1.4571

Stem

8 mm diameter, stainless steel 1.4571

The active length of the stem depends upon the diameter and the scale range.

Dial

White aluminium with black lettering per DIN EN 13 190

Pointer

Adjustable black aluminium pointer

Window

Laminated safety glass

Optional extras

- Liquid damping
- Ingress protection IP 66 (not for gauges with alarm contacts)
- Scale °F, K; dual scale °C/°F
- Window of non-splintering plastic
- Stem 6, 10 or 12 mm diameter
- Stem with integral thread connection or other connections
- Thermowells per DIN 43 772 or to user specifications
- Alarm contacts (see data sheet AC 08.01)



Scale, measuring ranges ¹⁾, limits of error per DIN EN 13 190, class 1

Scale range °C	Scale spacing °C	Measuring range ¹⁾ °C	Limit of error °C
- 80 ... + 60	2	- 60 ... + 40	2
- 60 ... + 40	1	- 50 ... + 30	1
- 40 ... + 60		- 30 ... + 50	
- 30 ... + 50		- 20 ... + 40	
- 20 ... + 60		- 10 ... + 50	
- 20 ... + 80		- 10 ... + 70	
0 ... 60		- 10 ... + 50	
0 ... 80	+ 10 ... + 70	2	
0 ... 100	+ 10 ... + 90		
0 ... 120	+ 10 ... + 110		
0 ... 160	+ 20 ... + 140		
0 ... 200	+ 20 ... + 180	2.5	
0 ... 250	+ 30 ... + 220		
0 ... 300	+ 30 ... + 270		
0 ... 400	+ 50 ... + 350	5	
0 ... 500	+ 50 ... + 450		
0 ... 600	+ 100 ... + 500		
0 ... 700	+ 100 ... + 600	10	

Models

Model	Nominal size	Location of stem / Case
S 7304	100	Centre back / adjustable every angle
S 7305	160	

¹⁾ The measuring range is indicated on the dial by two triangular marks.
Within this range the stated limit of error is valid according to DIN EN 13 190.

Dimensions

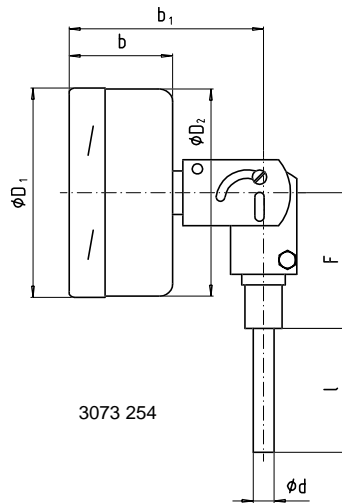

Nominal size	Dimensions in mm										Weight in kg
	alarm contacts of model 811, 821 or 831						d	D ₁	D ₂	F	
	without		1 or 2		3						
b	b ₁	b	b ₁	b	b ₁						
100	50	93	88	131	–	–	8 ¹⁾	101	99	68	1.300
160					97	140					

1) Option: stem diameter 6, 10, 12 mm

Design of connection

Dimensions in mm

Connection 1

Plain stem

Length of stem $l = 140, 200, 240$ or 290 mm

Stainless steel 1.4571

To fit compression fitting of connection no. 4

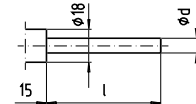

Connection 2

Male nut G 1/2 B

Length of stem $l_1 = 80, 140, 180$ or 230 mm

Stainless steel 1.4571

Male thread G	SW	i
G 1/2 B	27	20

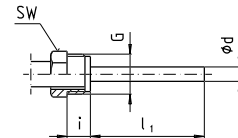

Connection 3

- Union nut G 1/2, G 3/4 or M 24 x 1.5

Length of stem $l_1 = 89, 126, 186, 226$ or 276 mm

Stainless steel 1.4571

Female thread G ₁	SW	i
G 1/2	27	8.5
G 3/4	32	10.5
M 24 x 1.5	32	13.5

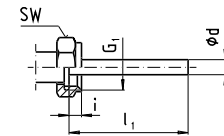

Connection 4

Compression fitting (sliding on stem)

G 1/2 B, G 3/4 B, M 18 x 1.5, 1/2 NPT or 3/4 NPT

Minimum insertion length l_{min} approx. 60 mm, $d_{min} = \varnothing 8$ mm

Length of stem $l_1 =$ variable

Length $L = l_1 + 40$ mm

Stainless steel 1.4571

Male thread G	SW	d ₄	i
G 1/2 B	27	26	14
G 3/4 B	32	32	16
M 18 x 1.5	24	23	12
1/2 NPT	22	–	19
3/4 NPT	30	–	20

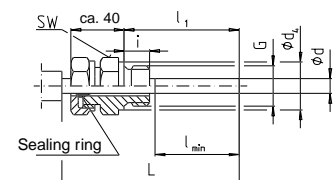

3073 050.04

Ordering information

Model / Nominal size / Scale range / No. and size of connection / Length of stem l, l_1 / Optional extras required

Specifications and dimensions given in this leaflet represent the state of engineering at the time of printing. Modifications may take place and materials specified may be replaced by others without prior notice.



WIKA Alexander Wiegand GmbH & Co. KG
 Alexander-Wiegand-Straße · 63911 Klingenberg
 Tel.: (0 93 72) 132-0 · Fax: (0 93 72) 132-406
<http://www.wika.de> · E-mail: info@wika.de